

MOBILE SUIT GUNDAM THE WITCH FROM MERCURY

# GUNPLA BEGINNER'S GUIDE

HOBBY JAPAN MOOK

**ULTIMATE TUTORIAL GUIDE!**  
Tips for Perfect Panel Lining  
Posing Lesson for Cool Photos  
Easy Makeup Techniques  
for Girl Plastic Kits  
Latest "G-Witch"  
Kits Catalog

G-WITCH MODELING GUIDE

**LET'S START BUILDING GUNPLA!**

Introducing practical techniques for entry-level modelers, ranging from simple finishing techniques that accentuate the mold colors to full painting finishes





SAMPLE

MOBILE SUIT GUNDAM

# the WITCH from MERCURY

## GUNPLA

BEGINNER'S GUIDE



©Sotsu•Sunrise•MBS



MOBILE SUIT GUNDAM THE WITCH FROM MERCURY  
**GUNPLA BEGINNER'S GUIDE**

HOBBY JAPAN MOOK

CONTENTS

- Index 4
- Chapter 1: How to Begin Building G-Witch Gunpla 6**
  - Level 1: HG Gundam Aerial Assembly Guide by Teppei Hayashi (Published in the December 2022 issue of *Monthly Hobby Japan*) 8
  - Level 2: HG Gundam Aerial Assembly Guide by KENTAROU (Published in the March 2023 issue of *Monthly Hobby Japan*) 12
  - Level 3: HG Gundam Aerial Assembly Guide by KENTAROU 16
- Gunpla Easy Photography and Posing Tutorial Using Your Smartphone (Published in the March 2023 issue of *Monthly Hobby Japan*) 22
- XVX-016 Gundam Aerial (with the Mirasoul Flight Unit) by Rikka (Published in the March 2023 issue of *Monthly Hobby Japan*) 24
- XGF-02 Gundam Lfrith by DAISAN (Published in the November 2022 issue of *Monthly Hobby Japan*) 28
- MSJ-105CC Chuchu's Demi Trainer by Netarou23 (Published in the January 2023 issue of *Monthly Hobby Japan*) 32
- MD-0032G Guel's Dilanza by Keisuke Watanabe (Published in the December 2022 issue of *Monthly Hobby Japan*) 36
- MD-0064 Darilbalde by Emeth@ifrit (Published in the February 2023 issue of *Monthly Hobby Japan*) 40
- FP/A-77 Gundam Phract by Keisuke Watanabe (Published in the February 2023 issue of *Monthly Hobby Japan*) 44
- CFK-029 Michaels by EARLY CHOP (Published in the March 2023 issue of *Monthly Hobby Japan*) 48
- XVX-016RN Gundam Aerial Rebuild by Kazuhiko Aikawa (Published in the May 2023 issue of *Monthly Hobby Japan*) 52
- Chapter 2: Design a cute makeup style for a girl plastic kit! 56**
  - Suletta Mercury by urahana3 (Published in the December 2022 issue of *Monthly Hobby Japan*) 57
  - Make her even cuter! Learn to build a kit with these tips by KOBOPANDA 60
  - Miorine Rembran by Emeth@ifrit (Published in the March 2023 issue of *Monthly Hobby Japan*) 64
- Chapter 3: Mobile Suit Gundam: the Witch from Mercury Gunpla Catalog 67**
- Publication info 82

\*All prices listed in this book include taxes.  
\*\*Plamodel is a registered trademark owned by the Japan Plamodel Industry Association.

# 1 How to Begin Building G-Witch Gunpla

The latest Gundam TV anime series, *Mobile Suit Gundam: the Witch from Mercury*, has just finished airing. In conjunction with its release, BANDAI SPIRITS has made available the series' mobile suits as Gundam plastic models, or Gunpla. There is no right or wrong way to finish a Gunpla, as each user is free to build it as they see fit. In fact, complete modified kits can be seen in model magazines and on websites, where people have used techniques like decal application, panel lining, and painting. This book is organized by theme and describes numerous Gunpla building and painting procedures in detail. It is a must-read for anyone interested in getting started with Gunpla or learning more about other techniques. By turning the pages, you'll find the G-Witch kit you want to build and the finishing style you want to use.

With this book in hand, let's build the Witch from Mercury Gunpla!

What do you want to know about building Gunpla?

1: Cutting and assembling the parts ▶ **Page 8**



Modern Gunpla incorporates the latest BANDAI SPIRITS technology, allowing you to create a cool 3D object simply by removing parts from a frame known as a "runner" and assembling them according to the instructions in the assembly manual. The only tool required is a nipper, and no adhesive is necessary. If you're new to Gunpla, start by carefully cutting out the parts and assembling them according to the instructions. With minimal effort, your Gunpla will be completed shortly, and you'll be able to play with it immediately.

2: Applying stickers ▶ **Page 9**

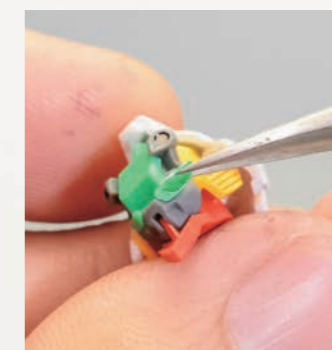

The next step is to apply stickers. For example, let's take the HG Gundam Aerial kit. While the kit itself is already quite colorful, it comes with stickers to enhance the eyes and complement the colors of small sections. If you carefully apply these stickers with tweezers, your Gunpla will look even better. Furthermore, there are thin stickers called "water slide decals" that can be placed in water and applied. Although they require some skill to apply, they can produce a more precise finish.

3: Panel lining ▶ **Page 9, 13**

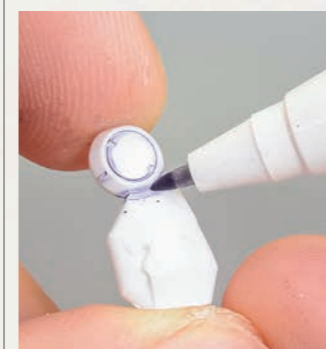

Gunpla parts may have fine grooves on their surface called "molds." These molds contribute to the mechanical appearance, and when gray or black ink is applied to them, they become more defined, adding depth and detail to your Gunpla and making it even cooler. You can use various methods, such as Gundam markers or enamel paints, to achieve this effect, so try it out in a way that suits your taste.

4: Painting ▶ **Page 14, 17**



Gunpla can also be painted, but it's not necessary to paint everything. You can use a method called "partial painting," where you only paint the parts you want to change and leave the other parts in their original color. Alternatively, the "full painting" method, where you completely paint over the Gunpla with your preferred color, is also popular. There are countless options for painting techniques, depending on whether you use a brush, an airbrush, or other painting equipment. However, this book introduces several recommended methods for beginners. If you are unsure, please refer to it.

# HG Gundam Aerial Assembly Guide

LEVEL: 1

BANDAI SPIRITS 1/144 scale, plastic kit "High Grade" Aerial XVX-016 Gundam Aerial  
Assembly and commentary Teppei Hayashi

## Parts Removal, Panel Lining, and Partial Painting using markers

In this section, we will explain step-by-step how to assemble a Gunpla using the HG Gundam Aerial, the protagonist's mobile suit from *Mobile Suit Gundam: the Witch from Mercury*. While the HG Gundam Aerial looks cool enough when straight built following the manual, you can make it look even sleeker and more polished by applying panel lining and partial painting with Gundam markers. First, we will cover a basic process that requires only a limited number of tools and procedures to achieve a cool finish without much hassle!



**Teppei Hayashi**  
He is a member of the Hobby Japan editorial staff, possessing top-notch modeling skills and being well-versed in all genres of models.



■ **Tools and materials**

■ **Tools**

◀ Plastic model nipper. Used to cut out parts. If you are making a Gunpla for the first time, a standard double-edged nipper is recommended.

◀ A design knife comes with a thin and sharp blade that is useful for cleanly cutting off gates on plastic parts, especially for clear parts and parts with shapes that are prone to forming marks when cut with nippers.

◀ Tweezers are a common tool used when attaching stickers to Gunpla. Many of the stickers included with Gunpla are small, making it difficult to attach them accurately with your fingers alone. By using tweezers, you can easily pick up even the smallest stickers, making the task much easier and more precise.



■ **Gundam Markers**

◀ The Gundam Real Touch Marker is a water-based marker designed for painting on plastic without causing damage. It's commonly used for panel lining on Gunpla. In this case, I will use Real Touch Gray 1, Gray 2, and Orange for panel lining.

◀ The Gundam Marker Panel Liner in black is an oil-based drawing pen designed to achieve a crisp panel line by filling in details solidly.

◀ The Gundam Marker in Gundam Gray is an alcohol-based marker used for coloring. It is highly versatile because its tint is close to the color of the joints that are widely used in Gunpla. For this reason, it is recommended as the first marker for beginners who want to engage in partial painting.









### STEP-1 ■ Cutting out parts cleanly!

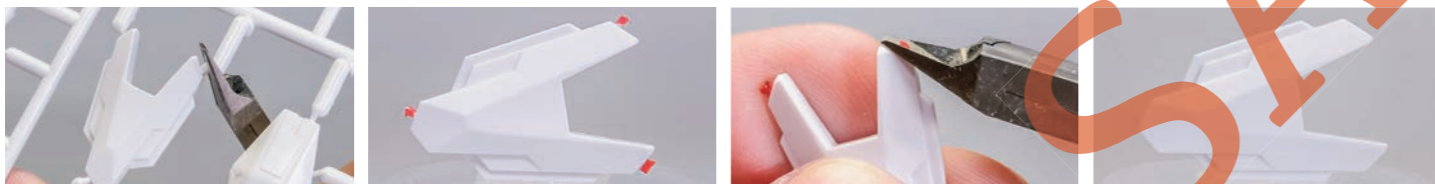

▲ First, let's start with the very basics: cutting out the parts. Use nippers to cut the parts out from the runner. When you make a cut, leave a small gap and avoid cutting the parts directly with the nipper's blade, as this could damage them. Instead, cut the parts leaving a small gate (the part that is colored in red) attached, which can be removed later with a design knife or sandpaper.

▲ Align the nipper blades horizontally against the part and snip to cut the gate. The blades can be easily aligned against the part without being obstructed by the runner or other parts, allowing for a clean cut.

▲ The parts have been cleanly cut out! This is a super basic technique called "double cutting." Although you may be tempted to cut the parts directly with the runner, using this cutting method reduces the risk of damaging the parts and allows for a safer and smoother assembly process.



▲ Some parts have gates on curved surfaces, as shown in the photo. It can be challenging to align the nipper blades against curved surfaces, so gates tend to remain on the parts even with the double cutting method. In such cases, use a hobby knife to remove these gates. A hobby knife has a thin and extremely sharp blade, allowing you to cut the gates cleanly without leaving any marks on the parts. While it takes more time than the double cutting method, if you want your Gunpla to look even better, it is recommended to process all gates with a hobby knife.

▲ The Aerial model includes clear parts to reproduce the Shell Unit, but don't try to use the double cutting method with them! Clear parts are harder than other parts, so applying the double cutting method may turn the nub marks white, cloudy, or even crack the plastic. This damage can be more noticeable because the parts are transparent. Therefore, carefully cut the gate of the clear parts with a hobby knife. Since the blade can be easily damaged due to the hard material, replace it frequently to ensure a clean cut.

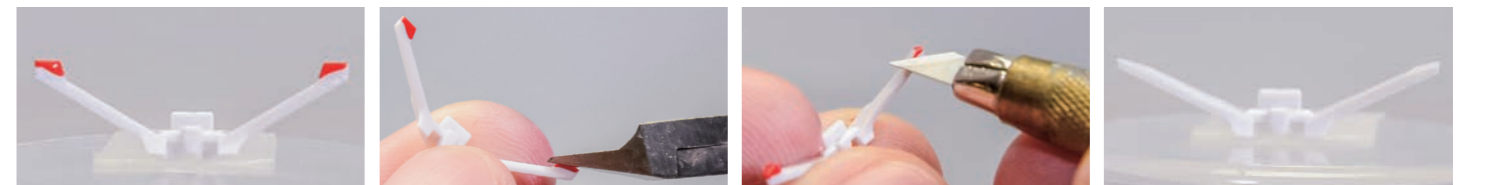

▲ The protrusion on the tip of the Aerial's blade antenna is called a "flag." It is there for safety to prevent sharp parts from piercing your hand. However, it is not originally part of the design, so let's cut it off and finish it more stylishly.

▲ The flag can be removed in the same way as cutting gates. However, the blade antenna is a very noticeable part. Simply using the double cutting method may leave a slight residue of the flag or damage the part due to over-cutting. Therefore, it's recommended to use a nipper to cut off most of the flag, leaving a little bit attached. Afterward, use a hobby knife to shave and shape it neatly.

▲ The flag has been cut, and the protrusions have been removed, resulting in a sharp antenna that matches the original design. It's not so difficult to achieve. Removing flags is straightforward; you can just think of them as larger gates. This technique is highly effective, so please give it a try!

### STEP-2 ■ Let's apply panel lining!

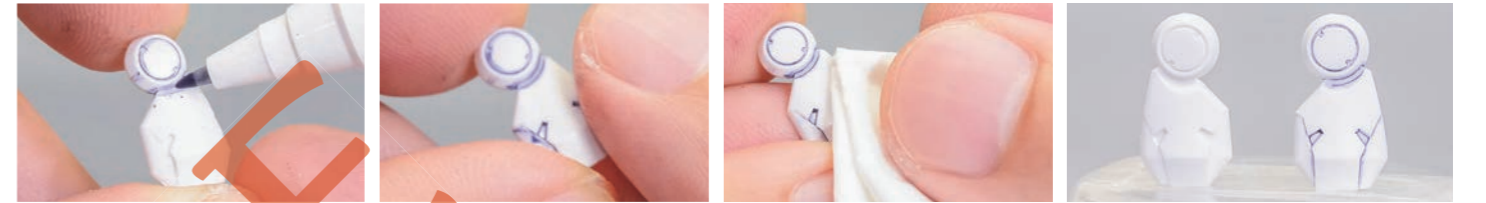

▲ What makes Gunpla charming are the delicate details, including precise panel lines. Let's add some panel lining to make it look even better. Begin by using a Real Touch Marker Gray 1 to draw lines on the panel lines and detailed parts.

▲ A small overflow can be wiped off with your fingertip. For bigger stains, use a tissue. The process is simple and only requires everyday items, so don't be concerned about any overflow!

▲ The panel lining has been done, and the coloring of details has significantly upgraded the overall look. However, using black for panel lining on white parts may appear too heavy. In these circumstances, use a Real Touch Marker Gray 1 with a light purple-gray tone for a more refined finish.

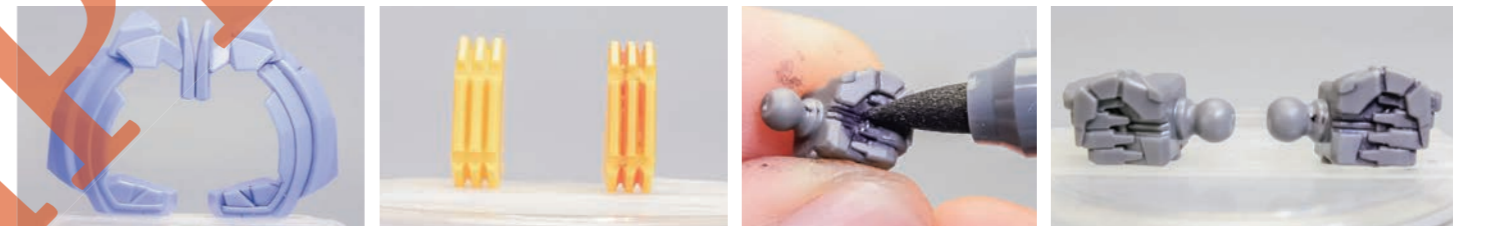

▲ The blue parts on the chest were also panel lined with the Real Touch Marker Gray 1. Even if applied thinly, comparing it with an unlined piece shows that the 3D effect is emphasized enough.

▲ Using black or gray for panel lining can make the yellow parts look dirty, so I'll use a Real Touch Marker Orange instead. When panel lining lighter colors, using similar shades from the same color family will improve the color and give a beautiful finish.

▲ I will use Gray 2 for panel lining the gray joint parts instead of Gray 1. For areas with intricate parts, like fingers, I'll quickly panel line by drawing with the thick marker side and then wiping it off with a tissue.

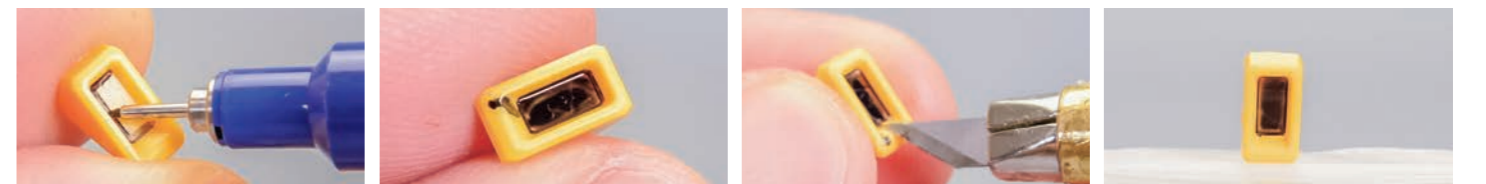

▲ To add depth to areas like the back of the thrusters where there are holes or deep details, I'll be using a black Gundam Marker for panel lining. Apply a solid black color to the deeply recessed areas to enhance their appearance.

▲ Oops! I accidentally went over the lines. Since the Gundam Marker for panel lining is oil-based, it cannot be easily removed with fingers or tissues. Accidentally going over the lines is common, but don't worry! It can be fixed, so it's okay.

▲ Using the tip of a hobby knife, I will scrape off the excess from the areas where I went over the lines. If only a small amount needs to be removed, scratching the surface of the part slightly is acceptable since it's barely noticeable. The easy mold color finish allows for the technique of directly scraping off excess paint.

▲ This is what it looks like after panel lining. The inside has been filled with solid black. Gunpla offers a variety of details, so it's recommended to use different markers to effectively enhance the details by changing the color and type according to the part.

### STEP-3 ■ Let's try putting on the stickers!



▲ Gunpla includes stickers for reproducing the colors. Although the HG Gundam Aerial has unique stickers, such as double-sided ones with patterns on the back, the process for applying them is still the same as with regular Gunpla. Let's apply the stickers now.

▲ The Aerial's official design can be replicated by assembling the green molded twin eyes, but applying stickers will enhance it. However, it can be challenging to apply the eye stickers accurately because they're so tiny. It's common for them to stick to the wrong place or lose adhesive because of the natural oils of the hands. Tweezers come in handy here, allowing for small stickers to be accurately placed with ease.

▲ The application of the eye stickers is complete. The stickers have a stunning shine that reflects ambient light, resulting in a stylish and sharp appearance. Misalignment is a common issue with individual eye stickers, like the ones used on the Aerial, and can be difficult to spot with the naked eye. To check alignment, zooming in on a smartphone photo can be helpful.

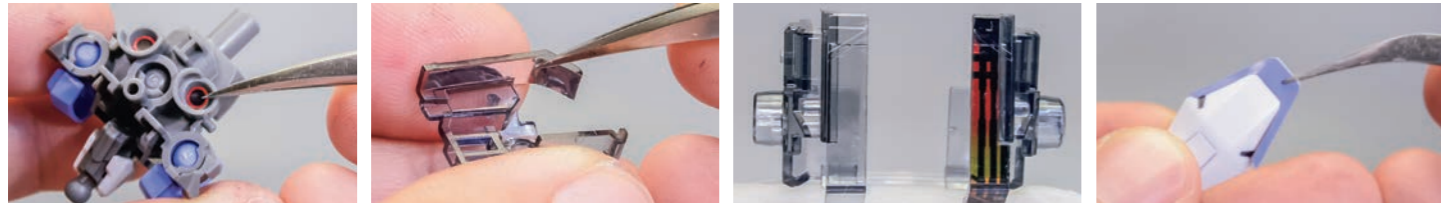

▲ Due to its hard-to-reach nature, applying stickers on the chest area can be challenging. A pair of tweezers can be useful in such situations, making the application of stickers simpler and resulting in a neat finish. It's good to always have them to hand!

▲ Positioning the double-sided tape inside the clear parts on the thighs can be tricky. Start by applying the tape at the narrow upper part and gradually align it while matching the curve of the corner. Using this method, you can attach things neatly.

▲ If the stickers are big enough, you can attach them using your fingers. However, using tweezers will make things much easier. After aligning the sticker's position with the curve of the part's edge, gently press and adhere the sticker with your finger to ensure it fits well on the surface.

### STEP-4 ■ Let's apply partial painting!

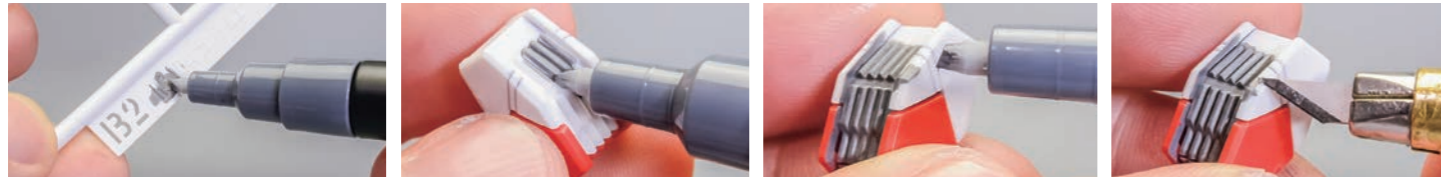

▲ Although the kit replicates the color scheme based on the designs, some small details cannot be reproduced using the kit alone. We'll use a Gundam Gray marker for partial painting. Before using the marker, ensure it is well-shaken and practice painting on runner tags or other materials to get familiar with its application. This way, you'll find it much easier to paint when working on the actual model.

▲ When painting with a Gundam Marker, it's important to effectively use the pointed tip. If you apply too much paint at once, it can overflow or cover areas unintentionally. Take care to apply the paint steadily and accurately using the pointed tip.

▲ Oops! The paint from the Gundam Marker has overflowed. But don't worry! Just like with panel lining using the Gundam Marker, you can remove it with a hobby knife.

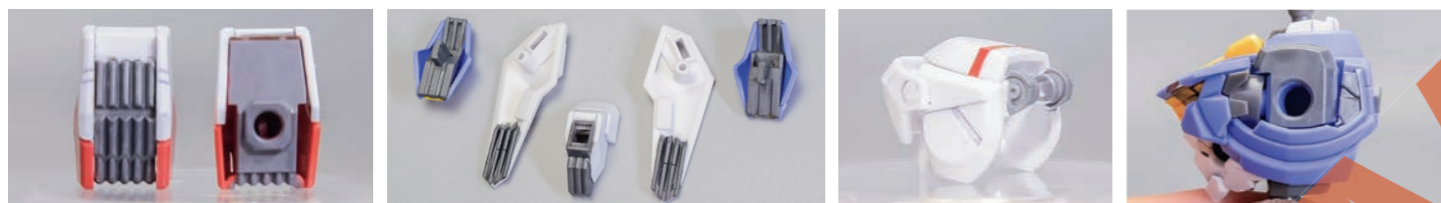

▲ Painting of the gray areas on the heel is complete. When partial painting with a marker, it's common to go outside the lines, so don't worry. I had some overflow on other parts, but I was able to fix them by carefully scraping and wiping off the excess paint in the end.

▲ Use gray paint to color the intricate parts that resemble overlaid plates in each section. Please refer to the photo for guidance. Applying color to hard-to-reach areas with the marker's tip can be a challenge. When this occurs, push the marker's tip onto a paint dish to dispense the paint and use a brush to apply it.

▲ To follow the official design, the gray area between the shoulder armor and the arm frame should be painted gray. Painting this area will give a more natural appearance to the frame. While the kit is already color-coded, painting with a marker is more about highlighting certain parts rather than matching the exact colors provided. Therefore, it's helpful to approach the task with the mindset of improving the overall appearance rather than striving for perfection.

### ■ HG Gundam Aerial is complete!



It's finally finished! Each Gundam series has a flagship model in the form of the main mobile suit, which is crafted with extreme attention to detail. The HG Gundam Aerial looks stunning, just like the rest of them. For those who are inspired to build a Gunpla after watching the new Gundam, I've created a guide that focuses on partial painting and panel lining techniques. The feeling of completing a Gunpla you've worked hard on is unparalleled. I encourage you to give it a shot!



Straight build



▲ I have set up the Gundam Aerial that I constructed (on the right) and positioned it next to the unmodified build (on the left). When compared, the custom model seems significantly more polished and refined.

▲ Let's summarize the main points from this session! Apply black panel lining to enhance the beam vulcan parts. For yellow or blue components, use matching colors for panel lining. Gray partial painting is a suitable option for shoulders and other joint parts.



Custom kit



▲ I improved the shield's detailing on the back and made it even more stunning by adding panel lining and partial painting.

▲ The addition of panel lining using Real Touch Gray 2 has given the beam blade a more three-dimensional look with added depth.



# HG Gundam Aerial Assembly Guide

LEVEL: **2**

BANDAI SPIRITS 1/144 scale, plastic kit "High Grade" Aerial  
**XXV-016 Gundam Aerial**  
 Assembly and commentary KENTAROU

## Seam removal, sharpening the antenna, and partial painting using a brush



**KENTAROU**  
 He is a plastic model enthusiast who has a magazine column named "Monthly Tools" in *Hobby Japan* magazine.

Let's move on to Level 2 techniques in the Gundam Aerial assembly guide. In this section, KENTAROU, a plastic model enthusiast, showcases practical examples of techniques that can enhance the overall appearance of the model. These tips will assist you in improving your model with minimal effort, including removing seam lines, sharpening antennas, and using water-soluble paints to color parts that are not in the mold color. Let's delve deeper into each of these techniques.

### Recommended paints



▲ Real Touch Marker series from Gundam Marker. These markers are designed to help you achieve a more realistic shading effect on your model. The colors in Set 1 are specifically tailored for the tricolor Gundam, making them ideal for enhancing its appearance.



▲ The paints I used for this project were Aqueous Hobby Color Gundam Aerial White, Blue, and Gray. These colors are essential when constructing the Gundam Aerial.



▲ The partial painting involved the use of MS Phantom Gray, Aotake (blue-green), Clear Red, and Gold.

### Useful tools



▲ For beginners in brush painting, the Tamiya Modeling Brush HF Standard Set is a cost-effective option that offers top-notch performance. You will get two flat brushes and one fine brush in this set, which will give you everything you need to begin.



▲ Tamiya Paint Stirrer. To ensure an even mixture, it is important to thoroughly mix the contents of the paint bottle before dispensing, as heavier particles tend to settle at the bottom. This simple stirrer tool is highly effective in achieving the desired consistency.



▲ For greater precision, it's recommended to use tweezers when applying stickers. Tamiya precision tweezers are a durable and reliable choice that will last a long time.



▲ To remove seam lines, use Mr. Cement S adhesive. It dries quickly, has a smooth texture, and maintains mold details, making it a reliable option.

### STEP-1 Cutting parts (recap)



▲ Double-cutting with nippers. The basic technique is to cut the gate at a distance.



▲ To remove a gate from a model kit part, position the blade of your hobby knife horizontally on the surface where the gate stems, and carefully cut through the remaining material.

### STEP-2 Applying stickers

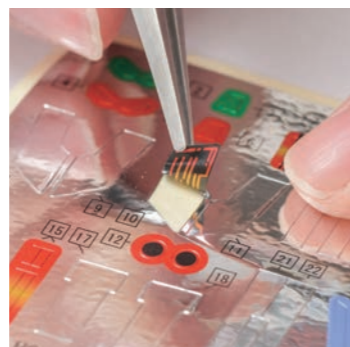

▲ A unique feature of the Gundam Aerial kit is the print on the sticker's adhesive surface. Use tweezers to handle the stickers and avoid touching the adhesive side.

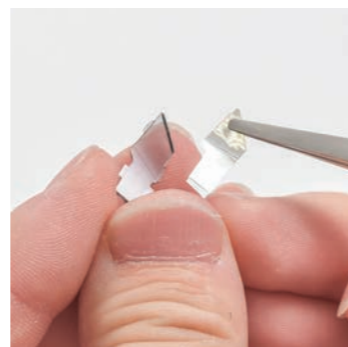

▲ When applying stickers, use steps or fold lines as guides to avoid misalignment. To ensure accurate placement, align the sticker at two points, such as the edge and middle guides.

### STEP-3 Seam removal



▲ Apply the liquid cement along the seam line once the parts are assembled. Allow enough time for the cement to fully set and securely bond the parts together.

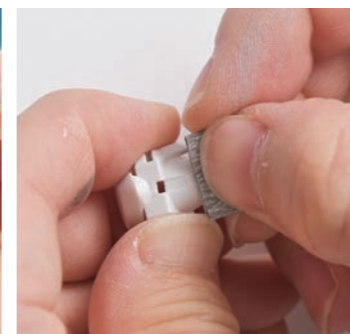

▲ After the cement is dry, use 600-grit sandpaper to even out the surface, sanding up to the edge of the part to avoid rough spots. For a refined look, focus on removing seam lines in the shoulder, knee, and shin areas, as they are the most noticeable.

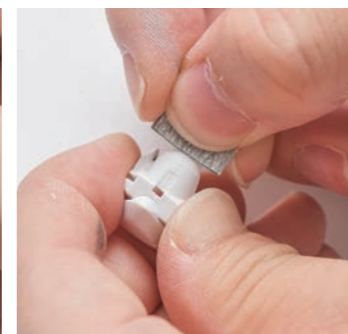

▲ Sanding the surface has made the seam line less noticeable.

### STEP-4 Sharpening the antennas



▲ The V-shaped antenna on the Gundam has large tips for safety reasons. To create the desired shape, carefully trim away the excess material. Take a deep breath and find the courage to make the cut!

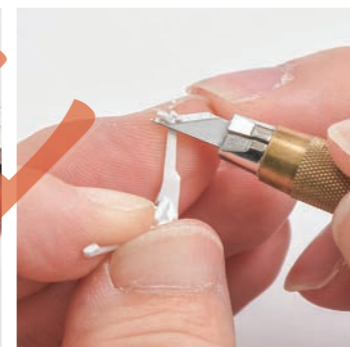

▲ Next, let's work on thinning out the antenna. Use a hobby knife to carefully trim the back of the antenna until it reaches the desired thickness.

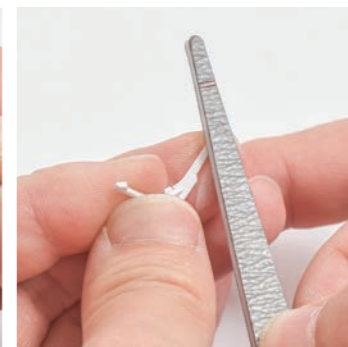

▲ Use a sanding stick to achieve a smooth and flat surface, removing any scratches left from previous steps using nippers or a hobby knife.

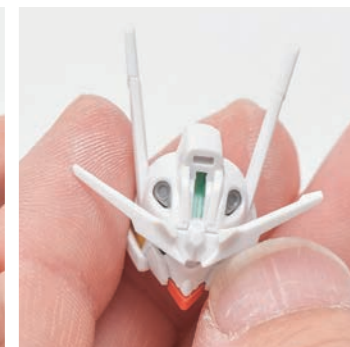

▲ The left side shows the finished result, while the right side shows the original shape. By trimming off the excess and thinning out the back of the antenna, the overall appearance has been significantly improved.

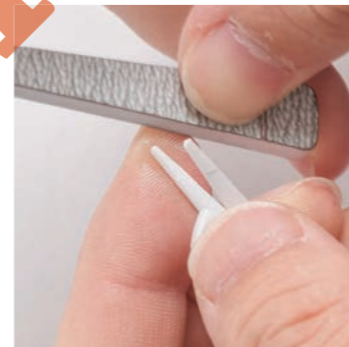

▲ Next, let's work on making the side antennas more defined by thinning them out. There is a parting line in the middle of the inner side, so be sure to smooth it out as well.

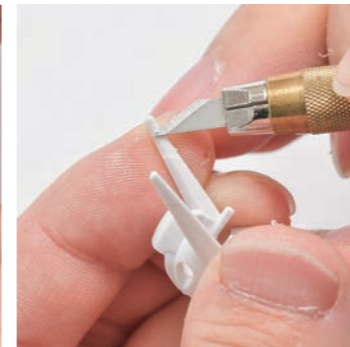

▲ Use a sanding stick and hobby knife to carefully cut and shape the antennas, being mindful not to remove any details.

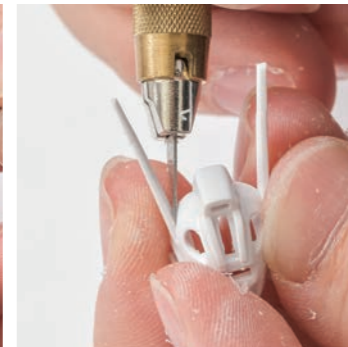

▲ Once the antenna has been thinned and shaped, make a V-shaped cut on the inner base of the antenna to create the appearance that it extends straight from the base.

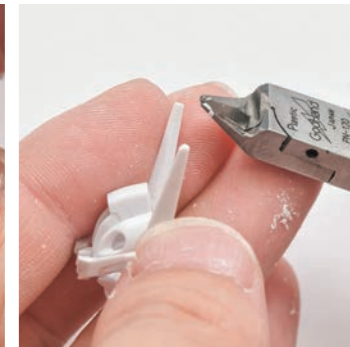

▲ Lastly, cut the tip of the antenna to match the official design. By shaping the rounded tip into a sharper, square shape, the antenna will look more defined and add to the overall sharpness of the model.

### STEP-5 Panel lining (part 1)

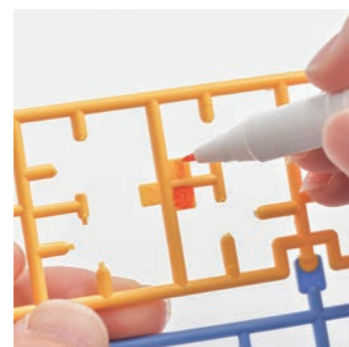

▲ When painting, it's recommended to test it out on the runner parts first. Begin by panel lining using a Real Touch Marker. For the yellow parts, orange is the ideal color choice.



▲ Let's try using a marker on the stepped areas and shaded parts. With just a quick stroke, the orange color came out quite nicely, adding a subtle but noticeable accent to the model.



▲ The set also includes a blending pen, which is useful for removing excess paint. By lightly brushing the pen across the surface, you can easily control the amount of paint applied and achieve a smoother finish.

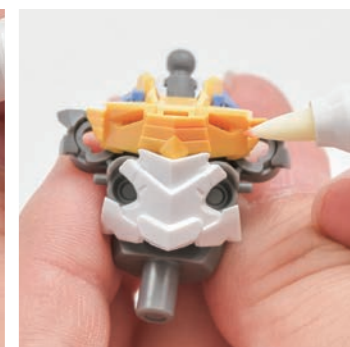

▲ By emphasizing the stepped areas, you can enhance the details of the model. Aerial benefits greatly from this panel lining technique. So, let's use it more and more to achieve a more polished and detailed finish.